

## IEC Appliance Connector C14, 70°C



6100-3

C14



70° C

**Description**

- Panel Mount:  
Screw-on from front or rear-side
- Inlet, Pin temperature 70 °C, Protection class I
- Solder terminals or quick connect terminals
- Alternative: protection class II version 6102-3

**Other versions on request**

- Types for rivet mounting available upon request

**Weblinks**Approvals: [www.schurter.com/approvals](http://www.schurter.com/approvals)RoHS: <http://www.schurter.com/rohs>**Technical Data**

Ratings IEC	10 A / 250 VAC; 50 Hz
Ratings UL/CSA	15 A / 250 VAC; 60 Hz
Dielectric Strength	> 2 kVAC between L-N > 2 kVAC between L/N-PE (1 min/50 Hz)
Allowable Operation Temp.	-25 °C to 70 °C
Degree of Protection	from front side IP 40 acc. to IEC 60529
Protection Class	Suitable for appliances with protection class I acc. to IEC 61140
Terminal	Solder terminals or quick connect terminals
Panel Thickness s	Screw-on: max 8 mm Mounting screw torque max 0.5 Nm
Material: Housing	Thermoplastic, black, UL 94V-0

Appliance-Inlet /-Outlet	C14 acc. to IEC/EN 60320-1, UL 498, CSA C22.2 no. 42 (for cold condition) pin-temperature 70 °C, 10 A, Protection class I
--------------------------	--

**Dimensions**

6100-3 (6102-3)

Length 48 mm

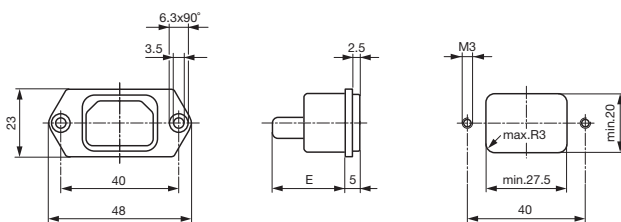

E: Solder terminals &lt;TAB/&gt;&lt;TAB/&gt;20.5 mm

E: Quick connect terminals &lt;TAB/&gt;23.5 mm

**Variants**

Type	Protection Class	Panel mounting	Panel Thickness s [mm]	Terminal	Order Number
6100-3	I	Screw-on	-	Quick connect terminals 4.8 x 0.8 mm	6100.3200
6100-3	I	Screw-on	-	Quick connect terminals 6.3 x 0.8 mm	6100.3300
6100-3	I	Screw-on	-	Solder terminals 3.5 x 0.8 mm	6100.3100

**Packaging unit**

50 Pcs

Accessory

---

## Description



Assorted Covers

Cord retaining kits

---